

SIGNATURE

NORTH EAST

OFFICIALLY RATED THE NO.1 ESTATE AGENT IN THE NORTH EAST





📍 Reid Street, Morpeth NE61 1TY

Reid Street, Morpeth NE61 1TY

Offers Over £125,000

Signature North East welcomes you to this charming two-bedroom terraced home in Morpeth. Ideally located near Morpeth Town Centre, the property enjoys easy access to a fantastic range of amenities, including the boutique shops of Sanderson Arcade, an array of bars and eateries, and plenty of nearby green space. Morpeth Train Station is also within close reach, providing convenient transport links for commuters.

Step into the welcoming living room, offering ample space for furnishings and featuring a charming fireplace alongside a large window that fills the room with natural light. The kitchen presents attractive wall and base units complemented by sleek countertops, creating a practical and stylish cooking space. The family bathroom completes the ground floor.

Continuing to the first floor, you'll find two well-proportioned bedrooms, one of which is a comfortable double. A convenient WC serves this level, adding further practicality.

Externally, the property benefits from a well-sized back yard, offering space for outdoor seating and relaxation. On-street parking is available nearby, adding ease for residents and visitors alike.



PLEASE NOTE THAT THE VENDOR HAS CERTIFIED THE PROPERTY INFORMATION AND IMAGES.

PROPERTY FLOORPLAN

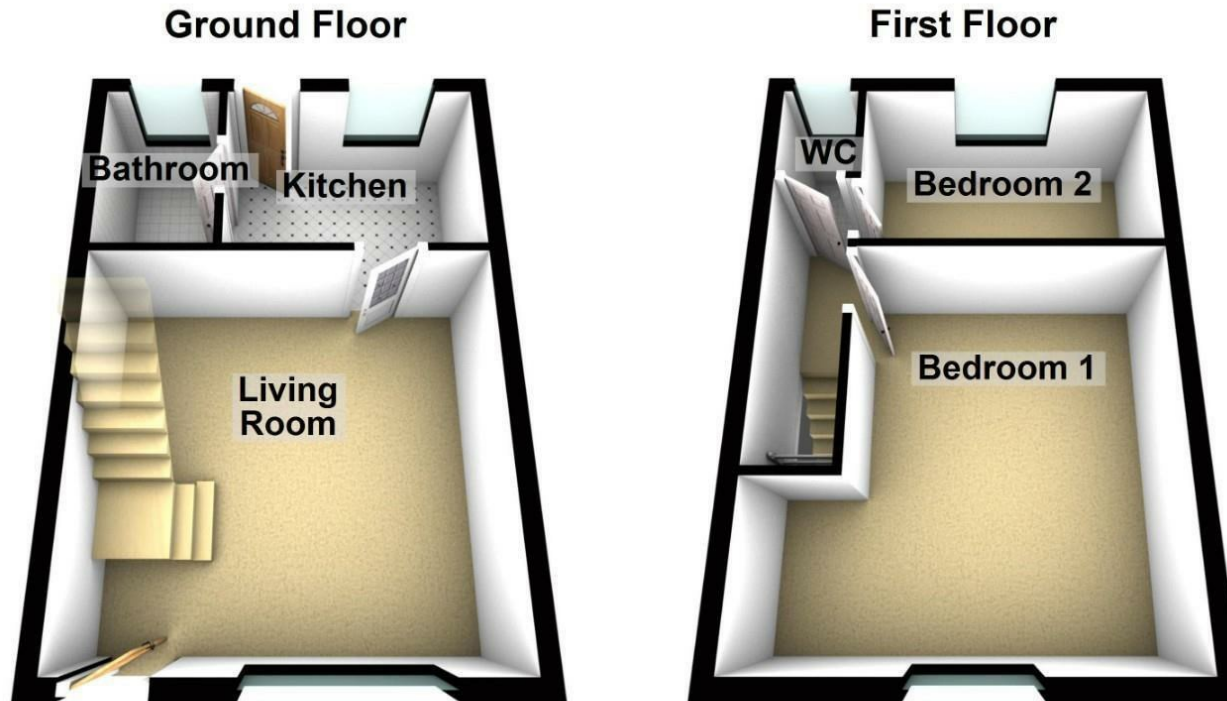

Please be advised the floorplans are not drawn to scale and are to be used to give an idea of the layout of the property.
Plan produced using PlanUp.

Measurements:

Living Room
14'0" x 6'6"

Kitchen
6'11" x 14'3"

Bathroom
4'6" x 6'9"

Bedroom One
14'0" x 10'0"

Bedroom Two
11'0" x 7'1"

WC
3'9" x 2'11"

Energy Efficiency Rating

	Current	Potential
Very energy efficient - lower running costs		
(92 plus) A		82
(81-91) B		
(69-80) C		
(55-68) D		
(39-54) E	42	
(21-38) F		
(1-20) G		
Not energy efficient - higher running costs		

England & Wales

EU Directive
2002/91/EC







More 5 Star Customer Reviews than any other Agent based in the North East on allAgents.co.uk



SALES

LETTINGS

FINANCE

LAW

WE COVER THE WHOLE OF THE NORTH EAST

Whitley Bay
0191 251 3344

Cramlington
01670 897 213

Tynemouth
0191 296 6689

Morpeth
01670 513 966

Ponteland
01661 820 082

Wallsend
0191 432 4151

Alnwick
01665 511 800

Heaton
0191 432 4275

Forest Hall
0191 266 9966

Other locations
0191 640 3523

Newcastle
0191 640 2284

Durham
0191 303 8252

Gosforth
0191 640 3523

Sunderland
0191 543 6390

Whickham
0191 432 5102

Gateshead
0191 432 4294

Jesmond
0191 281 1037

Killingworth
0191 640 3602

Ryton
0191 413 9845

Head Office &
Lettings
0191 253 4815

*Highest recommended 5-star reviews than any other Estate Agent based in the North East on allAgents.co.uk - The UK's Largest Customer Review Website for the Property Industry & Awarded Best Estate Agency 2018 & 2019 - North East England by SME News